



## TECHNICAL RIDER

Godset  
Jens Holms Vej 5, 6000 Kolding  
+45 79 79 10 60  
[godset@kolding.dk](mailto:godset@kolding.dk)  
[www.godset.net](http://www.godset.net)

### CONTACT

#### General planning

Jacob Holst (+45 40 34 20 64 - [jaho@kolding.dk](mailto:jaho@kolding.dk))

#### Stage technique

Claus Breiner Henriksen (+45 52 50 60 74 - [clausbhenriksen@gmail.com](mailto:clausbhenriksen@gmail.com))



## **PA OG MONITORS**

All PA and 6 monitors are driven by D&B D80 amps. 2 monitors are driven by D12 amps.

### **PA**

D&B Audio

4 x V8

4 x V12

4 x V-sub

1 x J-ultra sub

1 x J-infra sub

<http://www.dbaudio.com/en/systems/black-range/v-series>

### **MONITORS**

8 x D&B M4 2-way active on 6 sends

### **FOH**

### **MIXER**

Soundcraft Vi4:

64 preamps

96 desk handles

32 busses (assignable for groups, aux'es, matrixes and effects)

8 lexicon FX

<http://www.soundcraft.com/products/product.aspx?pid=14>

Ipad for remote

Patchbay (mounted on stage wall US SL)

Remote boxes and passive monitor split

## **MICROPHONES**

2 x Audix D2

1 x Audix D4

1 x Audix D5

1 x Audix D6

4 x AKG D7

1 x AKG D5

1 x AKG D 112

5 x AKG C214

2 x AKG 535 EB

1 x N/D 408B

1 x RE 27 N/D

1 x Sennheizer MD 421

4 x Sennheizer E 604 (clips til tomer)

4 x Sennheizer E 504 (clips til tomer)

2 x Audio-Technica At 2020

2 x Audio-Technica ATM 250 DE

10 x Shure SM 57

4 x Shure SM 58

2 x Shure SM 81

1 x Shure Beta 52A

1 x Beta 56 A

1 x Beta 57 A

9 x Shure Beta 58A

1 x Shure Beta 87

1 x Shure Beta 91 A

## **STANDS**

10 x small with boom

18 x large with book

3 large without boom ("soloist"-stands)

## **LINEDRIVERS**

8 x Klark Teknik LBB

4 x Radial Pro passiv DI

1 x Radial Pro 2 stereo DI

# LIGHT

## CONSOLE

Avolites Tiger Touch

## STAGE TRUSS

8 x Robe Robin 300 wash LED (mode 2)  
12 x Robe Viva RNS 2 Cmyk  
38 x PAR (OW)  
2x 2 way blinder

## FRONT TRUSS

5 x spot  
4 x Fresnel  
2 x 2way blinder

## HAZER

1 hazer

## DIMMERS

30 Ch 3kw Elektron for PARs

## RIG

Fronttruss: 6 m TX 25cm 3-angle truss  
Over stage: 7 x 3 m grid TX25 3-angle truss,

## VARIOUS

Mirror ball

## LODE STAR

6 x Lodestar DC D8+ F 250 kg  
1 x Kinesys digital hoist control with remote

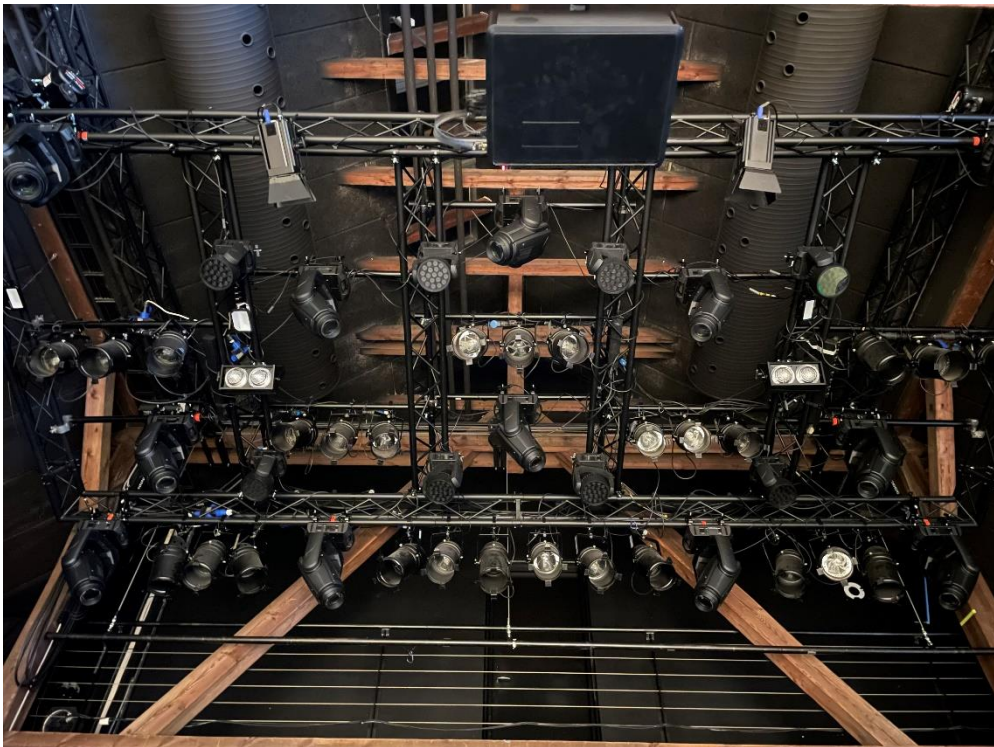
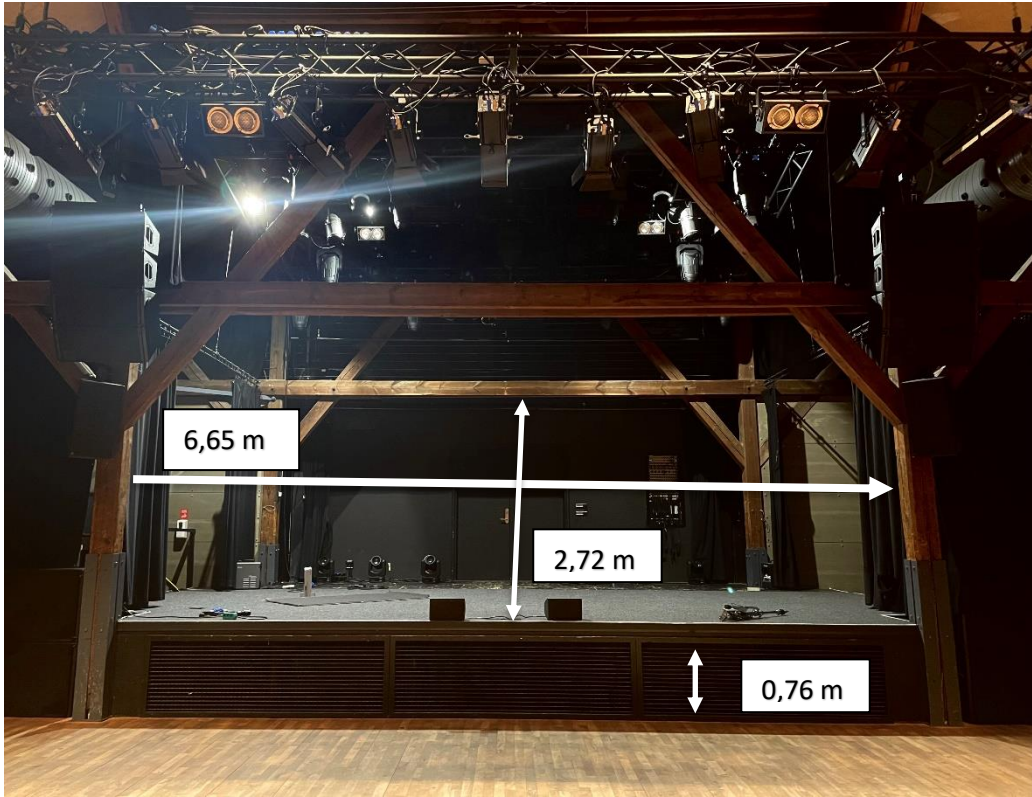

## **POWER**

Part from power to drive in house equipment, there is power as follows:

220 V under stage

1 stk. 3x63 A CE under stage, stage left

1 stk 3X63 A CE backstage, stage left

Mobile PSU (supplied with 63 A) with various outlets

You can not draw full supply from all sources simultaneously.

There is no 110 v

## **STAGE**

Please see drawing

Height: 76 cm

Width:

6,65 m between columns

8,90 m from edge to edge

Depth:

If artist brings backdrop:

4,4 m from front stage to backdrop

Clearance depends on truss height

There are tie beams 2,72 m and 5,60 m from stage floor surrounding the stage.

There is an additional 1,10 m depth with reduced clearance, 2,72 m ( behind backdrop, if backdrop)

All measures differ slightly, since it is an old house

## FLOORPLAN, STAGE:

SL

DOWNSTAGE

SR

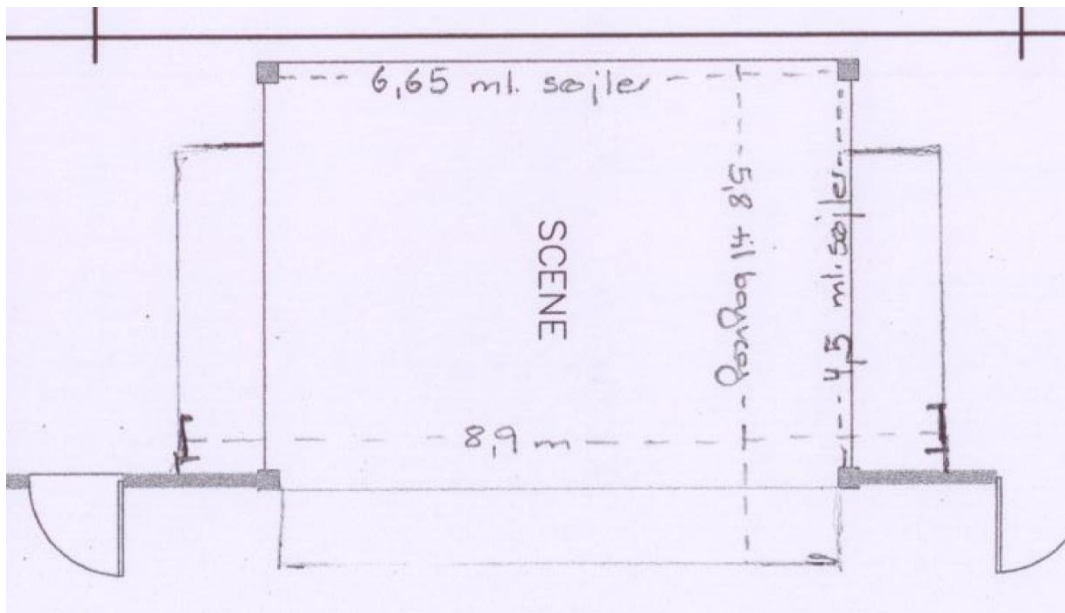

UPSTAGE

### RISERS

8 risers in all ( 1x2 m)

legs in fixed sizes:

Ben i faste størrelser:

75 cm (for max 6 risers)

30 cm (for max 6 risers)

20 cm (for max 5 risers)

### PROJEKTOR, CAMERA, AND SCREENS

Projector (HDMI acces from FOH or stage, stage left.)

screen on back wall

screen on each side of the hall, where show is transmitted with fixed camera position (no recording)



## **GREEN ROOMS / DRESSING ROOMS**

### **SMALL GREEN ROOM (1<sup>st</sup> floor)**

Room with direct access to stage:

Kitchenette

Table with 6 chairs.

Mirror, Vanity table, 220 V power

Refrigerator

TV

Private shower and toilet

### **"THE MAIL WAGGON" (ground floor)**



"The mail wagon" is a train waggon from 1964, which has been turned into a green room.

From the wagon there is direct access to the backstage and stage area, about a 4 meter walk under half roof.

Seats for 20 dining people

Small kitchen. Lounge. Toilet.

## **MERCHANDISE BOOT**

Depending on the use of the hall, merchandise boot can either be in a passage between the hall and the entrance hall ( see picture), or it can be placed in the entrance hall. The placement depends on the fire rules for the particular show and set-up. It is always the venue staff that decides the possibilities for placement.

Please notice, that we can not provide credit card or cash change facilities. Please be aware, that many persons in Denmark do not carry cash, only a credit card.

All tax and VAT issues concerning merch sales must be handled by artist.

### **MERCH BOOT IN PASSAGE:**

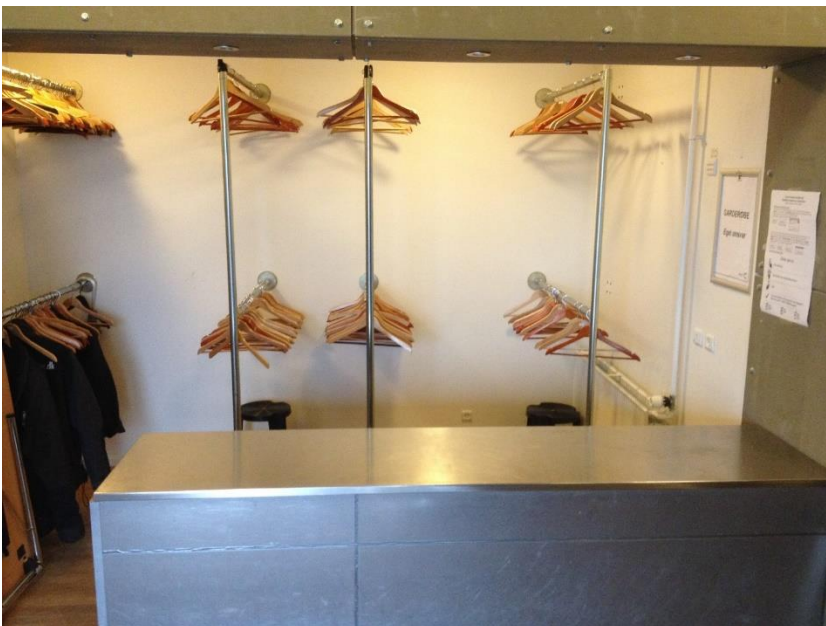

## **DRIVING ACCES, PARKING & SHORE POWER**

Free bus parking at rear end of the building (at load in). Shore power 16 CE single phase. 3x16 A is possible by prior agreement.



Godset

Jens Holms Vej 5

6000 Kolding

Denmark

[www.godset.net](http://www.godset.net) +45 79 79 10 60 / + 45 40 34 20 64